

LIFTING EYE BOLTS

DIN 580

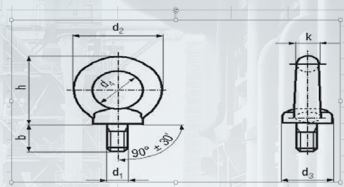

Standard	Thread Size d1												
	(M6)	M8	M10	M12	(M14)	M16	M20	(M22)	M24	(M27)	M30	(M33)	M36
DIN 580	(M6)	M8	M10	M12	(M14)	M16	M20	(M22)	M24	(M27)	M30	(M33)	M36
Thread Pitch	1	1.25	1.5	1.75	2	2	2.5	2.5	3	3	3.5	3.5	4
Fine Pitch				1.5		1.5	2		2		2		3
Ring OD d2	36	36	45	54	63	63	72	90	90	108	108	126	126
Ring ID d4	20	20	25	30	35	35	40	50	50	60	60	70	70
Ring Height to Include shoulder h	36	36	45	53	62	62	71	90	90	109	109	128	128
Ring Width k	8	8	10	12	14	14	16	20	20	24	24	28	28
Shoulder Diameter d3	20	20	25	30	35	35	40	50	50	65	65	75	75
Thread Length b	13	13	17	20.5	27	27	30	36	36	45	45	54	54

* All dimensions are in mm.

*All the data are from informative purpose only

Property Class	Stainless Steel
	A2 & A4
Finish	Plain

